

Dealer Name: _____

Dealer P/O # _____

Facility Name: _____

A9550 Series

Order # _____

Job # _____

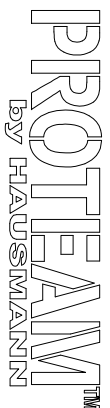

LAMINATE COLOR:
 346 Natural Oak
 927 Folkstone Gray
 5904 Wild Cherry
 Other: _____

VINYL COLOR:
 718 Navy Blue
 722 Dove Gray
 723 Forest Green
 724 Deep Wine
 725 Black
 726 American Beauty
 728 Claret
 729 Royal Blue
 731 Regimental Blue
 Other: _____

OPTIONS: (Mark on Drawing Where Required)

<input type="checkbox"/> A914 Extra Drawer	QTY: _____	<input type="checkbox"/> A944 Full Height Doors	QTY: _____
<input type="checkbox"/> A918 Full Extension Pull-Out	_____	<input type="checkbox"/> A945 Lock (Slide Access Doors or Drawers Only)	_____
<input type="checkbox"/> A923 3 Drawers (in lieu of Doors)	_____	<input type="checkbox"/> A946 Lock / Bolt (Double Doors Only)	_____
<input type="checkbox"/> A924 Waste Hamper & Cut-Out	_____	<input type="checkbox"/> A947 Wire Pull, Satin Finish	_____
<input type="checkbox"/> A941 Laminate Top (Taping Modules Only)	_____	<input type="checkbox"/> A927 Front Pull-Out Stand & Drawer	_____
<input type="checkbox"/> A943 Hinged Side Access Door	_____	<input type="checkbox"/> A929 Side Pull Out Stand	_____
		<input type="checkbox"/> A9250 Wall Pad, 24" X 24"	_____

Side Storage (As Shown)
OR
 Front Storage Only, w/Solid Sides (See Detail @ Left)

LOGO:
 A902 Deboss Vinyl
 A904-8 Emboss Vinyl
 A911 Laminate Wall Plate
 A912 Laminate Storage Top

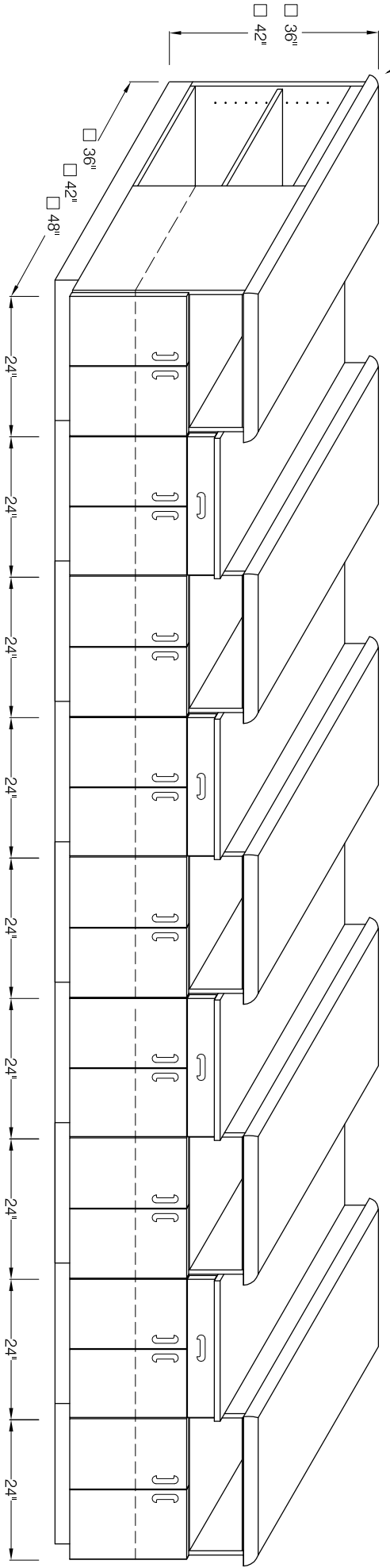

5 Seat Modular Taping Station - 18' Long