

Dealer Name: _____

Dealer P/O # _____

Facility Name: _____

A9512-A9517 Series

Order # _____

Job # _____

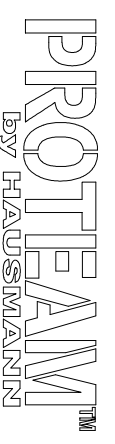

LAMINATE COLOR:

- 346 Natural Oak
- 927 Folkstone Gray
- 5904 Wild Cherry
- Other: _____

OPTIONS:

(Mark on Drawing Where Required)

- | | | | |
|-------------------------------|------------------------------|-------------------------------|---------------------------------|
| _____ | QTY: _____ | _____ | QTY: _____ |
| <input type="checkbox"/> A923 | 3 Drawers (In Line of Doors) | <input type="checkbox"/> A946 | Lock / Bolt (Double Doors Only) |
| <input type="checkbox"/> A924 | Waste Hamper & Cut-Out | <input type="checkbox"/> A947 | Wire Pull, Satin Finish |
| <input type="checkbox"/> A945 | Lock (Drawers Only) | <input type="checkbox"/> A927 | Front Pull-Out Stand & Drawer |

LOGO:

- A911 Laminate Wall Plate
- A912 Laminate Storage Top

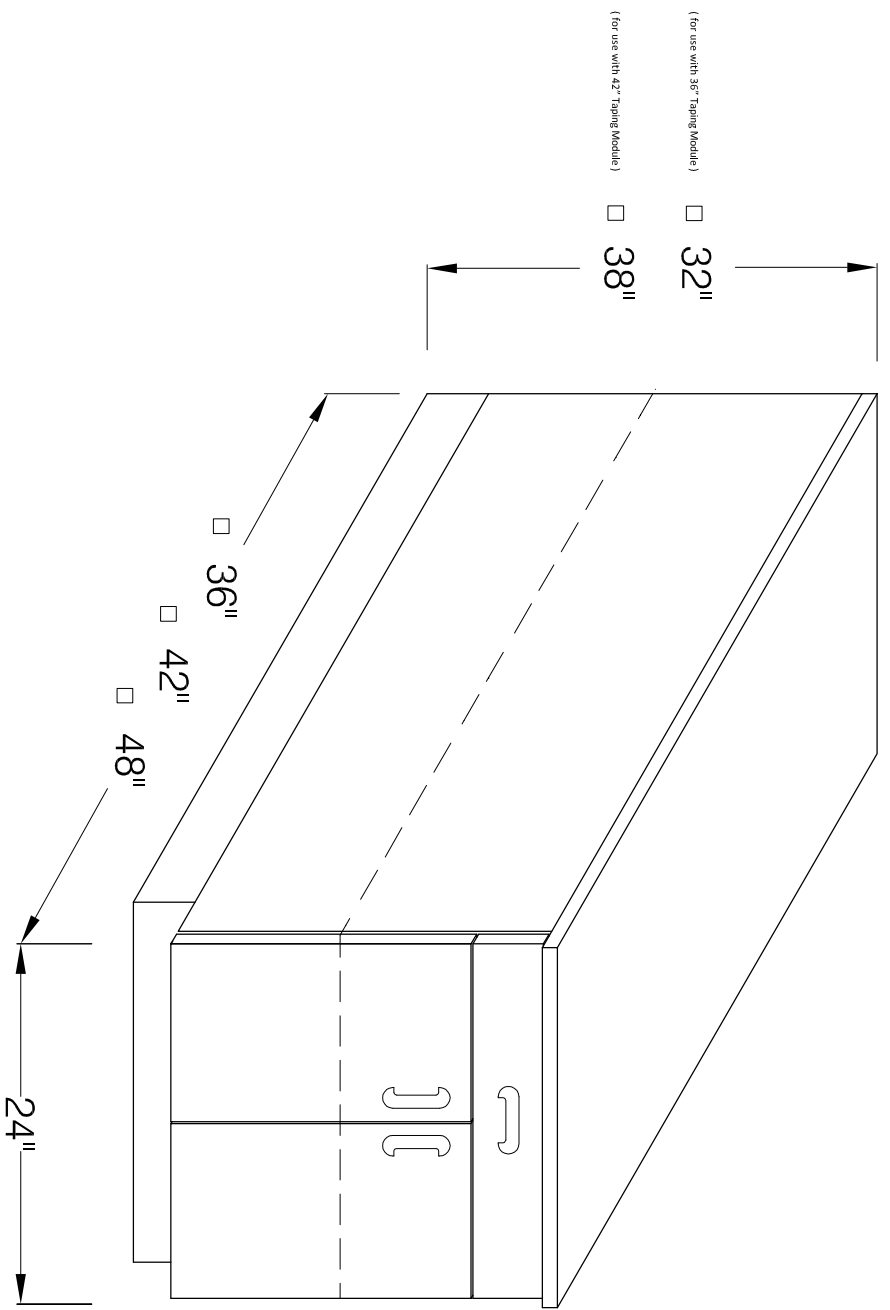

(for use with 36" Taping Module)

32"

(for use with 42" Taping Module)

38"

36"

42"

48"

24"